

AGENDA

Meeting: Pewsey Community Area Transport Group

Place: Pewsey Parish Office

Date: Wednesday 28 March 2018

Time: 2.00 pm

Please direct any enquiries on this Agenda to Mark Stansby (Senior Highways Engineer), direct line 01225 713367 or email mark.stansby@wiltshire.gov.uk

AGENDA

Membership of the CATG

For membership please click on the link below:

<http://modern.gov.wiltshire.council/mgCommitteeDetails.aspx?ID=1320>

1 **Note Tracker** (*Pages 3 - 28*)

The following information is included in the attached Note Tracker:

- Attendees and Apologies
- Approval of notes of the previous meeting
- Financial Position
- Top 5 Priority Schemes
- Other Priority Schemes
- New Requests/Issues
- Current / ongoing schemes
- Other items

2 **Date of Next Meeting**

6th June 2018 Pewsey Parish Council Office, 1400hrs

COMMUNITY AREA TRANSPORT GROUP ACTION / NOTES LOG

	Item	Update	Actions and recommendations	Who
	Pewsey CATG - Date of meeting: 28th March 2018			
1.	Attendees and apologies			
Page 3	Present:	J Kunkler, B Walker, T Eyles, G Ward, C Hollinsworth, Mac McLean, C Whistler, D Wilson, M Hyslop, J Brewin, M Read, M Stansby, R Dobson, S Colling, C Gale, V Litherland, A Flack.	Area Board to note.	
	Apologies:	R Nethercliff, D Pronto, S Drinkwater, D Shaw, H Hepworth.		
2.	Notes of last meeting			
		<p>The minutes of the previous meeting held were agreed at the Pewsey Area Board meeting on the 8th January 2018.</p> <p><i>Link can be found at:</i></p> <p>http://cms.wiltshire.gov.uk/ieListDocuments.aspx?CId=177&Mid=11148&Ver=4</p> <p>The Chairman noted that a 'one person issue' was insufficient to substantiate the case, however it was agreed that as each issue had to go to the relevant Parish council for agreement before it was tabled at CATG this gave the issue community validity.</p>	CATG to note	

COMMUNITY AREA TRANSPORT GROUP ACTION / NOTES LOG

3.	Financial Position			
Page 4		<p>The updated finance sheet for 2017 / 18 was presented by Mark Stansby showing a current balance of £5,274.28 (Appendix 1).</p> <p>The allocation to Pewsey CATG for 2018/19 is confirmed as £12,377.</p> <p>£184.60 had been received from the AB .</p>	Area Board to note.	Cllr Kunkler
	Top 5 Priority Schemes			
a)	<p>Issues 535 and 5032</p> <p>C52 Manningford - traffic management measures</p>	<p>Wilcot Parish Council content with the change of directional signs at Prospect. New signs to read “Local villages only”.</p> <p>Sign installation complete – final account = £4,906.03.</p> <p>Final Invoice to be sent to PC who will contribute 10% of the agreed initial estimate.</p>	Highways to invoice	Highways
b)	<p>Issue 3676</p> <p>North Newton Footway Improvements</p>	<p>Following a meeting between Highways & Parish Council it has been agreed to break the project down into smaller parts.</p> <p>A detailed design is to be completed for a 100m length commencing at Woodbridge roundabout along Rushall Road to produce a robust estimate.</p> <p>Highways currently liaising with BT concerning a cover / chamber which requires lowering.</p>	Detailed design and estimate to be produced for June CATG meeting	Highways

COMMUNITY AREA TRANSPORT GROUP ACTION / NOTES LOG

c)	Issue 2721 Woodborough 20 mph Zone	<p>Construction now complete. Highways awaiting independent safety audit.</p> <p>Invoice issued to Parish Council which has now been paid.</p>	Safety Audit to be completed	Highways
d)	Issue 72 & 3718 Pedestrian access to Pewsey Rail Station	<p>Update on alternative route from Cllr Kunkler and Parish Council.</p> <p>A site meeting was held on 23rd Mar with local MP, GWR and parish Cllrs. It was agreed that scheme design to include signage, low level solar lighting, bollards and groundworks (short pavement). PC to seek quotes etc to determine costs.</p> <p>Mark Stansby reminded the group that permission from the landowner(s) would be needed before any design work could take place.</p>	Apply to AB ,GWR etc for funding Review progress end Apr 2018	PC Cllr Kunkler
e)	Issue 91 Rushall Elm Row – new footway from Church Lane to Bus Stop	<p>Prelim design work now complete. Highways awaiting independent Safety Audit.</p>	Safety Audit to be completed	Highways
5.	Other Priority schemes			
a)	Issue 4885 Rushall – speed reduction village gates	<p>Construction Pack has been issued to Contractor.</p> <p>Work not yet started.</p>	Highways to chase contractor	Highways

COMMUNITY AREA TRANSPORT GROUP ACTION / NOTES LOG

Page 6	b)	Issue 4312 Shalbourne – request for 20 mph limit.	<p>The proposal is currently being advertised with the end of objection period closing on 9th April.</p> <p>The school travel plan dates back to 2010 and is considered to be out of date. It is not possible for funding to be allocated through the Taking Action on School Journeys initiative at this time.</p> <p>Formal advertisement out, no objects received so far. No reply to Highways briefing note received. Next phase design signing scheme.</p> <p>Parish have committed £1,500 to build and CATG £7,500</p>	<p>Respond to Highways request</p> <p>Design signage scheme.</p> <p>To recommend that £7,500 be allocated to implement this scheme and to move this issue to top 5 priorities</p>	<p>PC</p> <p>Highways</p> <p>Cllr Kunkler</p>
	c)	Issue 4305 Ram Alley – request for Unsuitable for HGVs signs	Signs now installed and invoice issued.	Recommend to AB this issue closed	Cllr Kunkler
	d)	Issues 4587 & 5347 Bottlesford – request for Unsuitable for HGVs signs	Signs now installed and invoice issued.	Recommend to AB this issue closed.	Cllr Kunkler
	e)	Issue 4831 Oxenwood – request for bend warning signs by The Hassock property.	<p>Sign installation complete – final account = £497.24.</p> <p>Final Invoice to be sent to PC who will contribute 17% of the agreed initial estimate.</p>	Highways to invoice	Highways

COMMUNITY AREA TRANSPORT GROUP ACTION / NOTES LOG

f)	<p>Issue 3723</p> <p>Woodborough – request for footpath provision on C261</p>	<p>Prelim design has been submitted to the Parish Council for comment (see Appendix 2).</p> <p>PC pleased with initial design but considering extending the path eastwards by 100m which would increase initial estimate of £23K.</p>	<p>PC to consider way forward and agree with Highways.</p>	<p>PC Highways</p>
g)	<p>Issue 5289</p> <p>B3087 Littleworth – request for village nameplates</p>	<p>Issue submitted 13/04/17</p> <p>Signs now installed – final account = £445.82.</p> <p>Final Invoice to be sent to PC who will contribute 20% of the agreed initial estimate.</p>	<p>Highways to invoice</p>	<p>Highways</p>
h)	<p>Issue 5522</p> <p>A338 Shalbourne Carvers Hill junction – Road Safety</p>	<p>Issue submitted 11/07/17</p> <p>Signing work to be completed by end of March – not yet started.</p> <p>Road markings to be included in next round of ad hoc lining work anticipated in the new financial year, funded centrally by highways.</p>	<p>Highways to chase contractor</p>	<p>Highways</p>
i)	<p>Issue 5563</p> <p>Burbage Taskers Lane, Eastcourt Road, Eastcourt, Suthmere Drive and Ailesbury Way – request for 20 mph speed restriction</p>	<p>Issue submitted 31/07/17</p> <p>Metrocounts have been ordered – results just in but not yet reviewed, ready for next CATG.</p> <p>PC to be sent results for information.</p> <p>The PC enquired if they could erect “20 is plenty” signs. These are not prescribed for use on the public highway and the Parish</p>	<p>Highways to prepare report</p>	<p>Highways</p>

COMMUNITY AREA TRANSPORT GROUP ACTION / NOTES LOG

		could be legally liable under some circumstances. If the 20 mph limit is implemented, then prescribed 20 mph repeater signs will be erected.		
6.	New Requests / Issues (Issues can be viewed in full from the Area Board Section on the Wiltshire Council Website)			
a)	Issue 5281 A345 Manningford – request for pedestrian warning signs	Submitted 06/04/17 PC and Highways to meet on site on 18 th April to discuss options.	Area Board to note.	Highways & PC
b)	Issue 5407 Great Bedwyn – Parking and Traffic Issues	Submitted 04/06/17 Multiple traffic problems in Bedwyn. Link with Issues 5547 and 5707 PC did not attend for third meeting	Recommend to AB to close this issue	Cllr Kunkler
c)	Issue 5482 C38 between Alton Barnes and Newtown (Knap Hill) – Road Safety	Issue submitted 29/06/17 A number of collisions, some damage only, have been reported by the Parish Council. Some of these are recorded on the personal injury collision database but are spaced over an approximate ½ mile distance and do not reflect a cluster site for immediate intervention. However, there is a trend in that these are single vehicle loss of control incidents in wet road conditions. This site has been included in the 2018 / 19 programme for re-texturing work to improve skid resistance.	Recommend to AB to close this issue	Cllr Kunkler

Page 8

NOT FOR PUBLICATION

COMMUNITY AREA TRANSPORT GROUP ACTION / NOTES LOG

d)	<p>Issue 5547</p> <p>Great Bedwyn Church Street – parking issues</p>	<p>Issue submitted 20/07/17</p> <p>Link with Issue 5407 - See note above</p>	<p>Recommend to AB to close this issue</p>	<p>Cllr Kunkler</p>
e)	<p>Issue 5567</p> <p>Chirton A342 – request for Footway outside of former public house Wiltshire Yeomen.</p>	<p>Issue submitted 01/08/17 and supported by Parish Council</p> <p>Ongoing development work taking place which does not include for a footway at the front of the development.</p>	<p>Highways Engineer to visit site and report back at next CATG meeting. He will advise as to the work needed to resolve this issue.</p>	<p>Highways Engineer</p>
f)	<p>Issue 5595</p> <p>Pewsey Milton Road – request for Footway from Ball Corner Roundabout to kissing gate, south west of Kepnal Junction</p>	<p>Issue submitted 11/08/17</p> <p>Link with Issues 5839 & 5840.</p> <p>The PC wish to explore calming measures – possibly a pinch point.</p> <p>Initial step for Highways to visit site before advising best way forward.</p>	<p>Arrange site visit</p>	<p>PC Highways</p>
g)	<p>Issue 5640</p> <p>Sharcott Drove – request for signs to moderate speed</p>	<p>Issue submitted 30/08/17 by Parish Council.</p> <p>A briefing note (see Appendix 3) was presented at the last meeting.</p> <p>PC advised that signage is required at both ends of the road, cattle grid markings were not. This raised the cost to over £1K and the PC will contribute £200</p>	<p>To recommend that £800 be allocated to implement this scheme and to move this issue to the priority list</p> <p>Highways to prepare design and estimate.</p>	<p>Cllr Kunkler</p> <p>Highways</p>

COMMUNITY AREA TRANSPORT GROUP ACTION / NOTES LOG

h)	<p>Issue 5669</p> <p>Pewsey North Street – request for pedestrian improvements from number 72 (opposite rail station)</p>	<p>Issue submitted 11/09/17</p> <p>The PC are unable to support this issue as the cost of making improvements is too high.</p>	<p>Recommend to the AB that the issue be closed.</p>	<p>Cllr Kunkler</p>
i)	<p>Issue 5707</p> <p>Great Bedwyn – request for access protection marking outside properties 13 and 14 High Street</p>	<p>Issue submitted 25/09/17</p> <p>Link with 5407 – see note above.</p>	<p>Recommend to the AB that the issue be closed.</p>	<p>Cllr Kunkler</p>
j)	<p>Issue 5709</p> <p>Pewsey Avonleaze Road Estate – request for traffic calming measures</p>	<p>Issue submitted 26/09/17 – supported by Parish Council</p> <p>Metro count ordered – awaiting results.</p>	<p>Check that the PC has raised the request for a Metrocount</p>	<p>PC</p>
k)	<p>Issue 5721</p> <p>Easton Royal The Street – Speeding concerns in 20 mph limit</p>	<p>Issue submitted 01/10/17</p> <p>Metro count ordered – awaiting results</p> <p>Average speed 26mph . No 20mph signs painted on road surface</p>	<p>Raise a new issue to paint the road marking signs.</p> <p>Recommend to AB to close this issue.</p>	<p>PC</p> <p>Cllr Kunkler</p>
l)	<p>Issue 5772</p> <p>North Newnton between Wildes Farm and Four Ways Corner – speeding concerns</p>	<p>Issue submitted 19/10/17</p> <p>Results of metro count indicates 85th percentile speeds of 42.3 mph.</p> <p><u>In a 40mph speed limit the following criteria will be applied;</u></p>	<p>Recommend to the AB that the issue be closed.</p>	<p>Cllr Kunkler</p>

COMMUNITY AREA TRANSPORT GROUP ACTION / NOTES LOG

		<p>40 to 46 mph 85th percentile = No Further Action (NFA) 46.1 to 50 mph 85th percentile = eligible for Community Speed Watch Over 50 mph 85th percentile = Subject to Police enforcement</p> <p>No further action to be taken at this site.</p>		
m)	<p>Issue 5800</p> <p>Pewsey Avonleaze Road junction with Broomcroft Road – request for dropped kerbs</p>	<p>Issue submitted 31/10/17 – Supported by Parish Council</p> <p>This is to be actioned under the Pavement Improvement Scheme (see Item 7b).</p>	<p>See pavement allocation agreed by CATG</p>	<p>Highways Engineer</p>
	<p>Issue 5803</p> <p>Manningford Bruce – request for bollards outside former Rectory</p>	<p>Issue submitted 31/10/17</p> <p>PC and Highways to meet on site on 18th April to discuss options.</p>	<p>Area Board to note.</p>	<p>Highways & PC</p>
o)	<p>Issue 5839</p> <p>B3087 Milton Road junction with Dursden Lane – request for traffic calming measures.</p>	<p>Issue submitted 08/11/17</p> <p>Link with Issue 5595 – see note above.</p>	<p>Site meeting to be held</p> <p>See issue 5595 above</p>	<p>Highways & PC</p>
p)	<p>Issue 5840</p> <p>B3087 Milton Road – request for footpath with street lighting from Dursden Lane to Pewsey</p>	<p>Issue submitted 08/11/17</p> <p>Link with Issue 5595 – see note above.</p>	<p>Site meeting to be held</p> <p>See issue 5595 above</p>	<p>Highways & PC</p>

COMMUNITY AREA TRANSPORT GROUP ACTION / NOTES LOG

q)	<p>Issue 5919</p> <p>C192 The Warren Savernake Road – speeding concerns</p>	<p>New Issue submitted 06/12/17 – supported by Parish Council</p> <p>This section of C192 was assessed when we considered the speed limit changes at Durley in 2016/17. See Appendix 4.</p> <p>The metro count result for the section applied for 50mph came out at 42mph so no further action. However it was agreed to hold a site meeting to see if warning signs are appropriate.</p>	<p>Arrange site meeting</p>	<p>PC Highways</p>
Page 12	<p>Issue 5998</p> <p>C351 Rushall Pewsey Road – request to consider traffic calming measures</p>	<p>New Issue submitted by Parish Council on 11/01/18</p> <p>Highways reported that calming features such as chicanes would require considerable investment and this would need to be prioritised prior to any design work taking place.</p> <p>It was agreed to place this on hold whilst schemes already on the priority list are developed.</p>	<p>Area Board to note.</p>	<p>Cllr Kunkler</p>
s)	<p>Issue 5999</p> <p>C351 Rushall Pewsey Road – request for study into volume of traffic using this route.</p>	<p>New Issue submitted by Parish Council on 11/01/18</p> <p>It was agreed to carry this to the June meeting to allow Spencer Drinkwater to prepare an estimate for a study.</p>	<p>Area Board to note.</p>	<p>Cllr Kunkler Highways</p>
t)	<p>Issue 6168</p> <p>A342 Upavon Andover Road – request for Geese warning signs</p>	<p>New Issue submitted by Parish Council on 27/02/18</p> <p>Warning signs of “Wild Fowl” are an option for consideration. A ball park figure to supply and erect 2 signs on new posts is £500.</p> <p>Agreed to proceed. PC will contribute 10% of cost.</p>	<p>To recommend that £450 be allocated to implement this scheme and to move this issue to the priority list</p> <p>Arrange site meeting</p>	<p>Cllr Kunkler PC Highways</p>

COMMUNITY AREA TRANSPORT GROUP ACTION / NOTES LOG

7.	Other items			
a)	Bridge repairs at Wood Bridge, North Newnton	Work due to be completed by 23 March 2018.	Recommend to AB to close this issue	Cllr Kunkler

COMMUNITY AREA TRANSPORT GROUP ACTION / NOTES LOG

<p style="writing-mode: vertical-rl; transform: rotate(180deg);">Page 14</p>	<p>b) Pavement and Footway Improvement Scheme</p>	<p>Pewsey has been allocated £7,426.47 for this purpose.</p> <p>Can be used for:</p> <ul style="list-style-type: none"> • Repairs to uneven pavements • Resurfacing • Enhancing and maintaining pedestrian areas (drop kerbs) <p>Cannot be used for:</p> <ul style="list-style-type: none"> • Cleaning / litter removal • New footways • Bridleways <p>Requests being considered:</p> <p>5801 - Pewsey 70 to 75 High St = £4.5K 5800 – Pewsey Broomcroft Rd / Avonleaze Rd = £700</p> <p>Easton Royal PC To discuss problem with Highways Engineer</p> <p>The above expenditure was agreed. Any residual funds to be allocated at Highway Engineer’s discretion.</p> <p>Burbage PC asked if they could construct a retaining wall to hold back a bank which was falling on to an exisitng footpath. In these circumstances the PC would be legally liable for the wall. Suggest that the Parish discuss this issue with Richard Dobson, Area Highways Engineer.</p>	<p>Area Board to note.</p>	<p>Cllr Kunkler</p> <p>Highway Engineer</p> <p>PC</p>
--	---	--	-----------------------------------	---

COMMUNITY AREA TRANSPORT GROUP ACTION / NOTES LOG

c)	Chirton – parking / traffic issues outside of school.	The final draft of The School Travel Plan has yet to be submitted by the school however a feasibility meeting has been arranged for the last week of April with representatives from the school.	Area Board to note.	Cllr Kunkler
d) Page 15	Local Highways Investment Fund 2014 – 2020	<p>Appendix 5 lists the Major Maintenance programme for 2018/19.</p> <p>Also listed are those sites currently awaiting treatment but not yet on the immediate programme. CATGs are being invited to comment on the reserve list and to put forward any alternative suggestions.</p> <p>The full report on Local Highways Investment Fund can be found on the Wiltshire Council website.</p>	Area Board to note.	Cllr Kunkler
e)				
8.	Date of Next Meeting: 6th June 2018, Pewsey Parish Council Office, at 14:00 hrs			

COMMUNITY AREA TRANSPORT GROUP ACTION / NOTES LOG

Pewsey Community Area Transport Group

Highways Officer – Mark Stansby

1. Environmental & Community Implications

1.1. Environmental and community implications were considered by the CATG during their deliberations. The funding of projects will contribute to the continuance and/or improvement of environmental, social and community wellbeing in the community area, the extent and specifics of which will be dependent upon the individual project.

2. Financial Implications

2.1. All decisions must fall within the Highways funding allocated to Pewsey Area Board.

If funding is allocated in line with CATG recommendations outlined in this report, and all relevant 3rd party contributions are confirmed, Pewsey Area Board will have a remaining Highways funding balance of **£5,138.27**

3. Legal Implications

3.1. There are no specific legal implications related to this report.

4. HR Implications

4.1. There are no specific HR implications related to this report.

5. Equality and Inclusion Implications

5.1 The schemes recommended to the Area Board will improve road safety for all users of the highway.

6. Safeguarding implications

7. Recommendations to Pewsey Area Board:-

7.1 To close the following Issues:

- 4305

COMMUNITY AREA TRANSPORT GROUP ACTION / NOTES LOG

- 4587
- 5347
- 5407
- 5482
- 5547
- 5669
- 5707
- 5721
- 5772
- Bridge repairs at Wood Bridge (See item 7a above)

7.2 To add the following Issues onto the Priority List and to approve funding:

- 5640 Sharcott Drove Warning Signs – CATG £800.00, Parish contribution £200.00.
- 6168 Upavon Warning Signs – CATG £450.00, Parish contribution £50.00

7.3 To promote the following Issue to the Top 5 Priority List and to approve funding:

- 4312 Shalbourne 20 mph limit – CATG £7,500.00, Parish contribution £1,500.00

This page is intentionally left blank

Pewsey CATG expenditure 2017 / 18 as of 14/03/18

Budget £12,377 + £25,438.93 c/fwd = £37,815.93

Scheme	Estimate	CATG Commitment	Expenditure	Projected Spend
Woodborough 20 mph Zone	£49,289.00	£3,000.00	£25,234.21 (interim)	£49,289.00
C192 Speed Limit (Durley)	£3,000.00	£2,700.00	£3,000.00 Final	£3,000.00
Oare Village gates	£2,300.00	£2,059.22	£2,459.22 Final	£2,459.22
C195 Speed Limit (Marten)	£3,000.00	£2,700.00	£2,594.39 Final	£2,594.39
Shalbourne 20 mph assessment	£2,500.00	£2,200.00	£2,500.00 Final	£2,500.00
Rushall Village Gates	£10,077.00	£8,565.00	£0,000.00	£10,077.00
Ram Alley Unsuitable HGVs signs	£400.00	£300.00	£0,000.00	£400.00
Bottlesford Unsuitable HGVs signs	£400.00	£300.00	£0,000.00	£400.00
Oxenwood Bend warning signs	£593.04	£493.04	£0,000.00	£593.04
Manningford Direction Signs	£5,800.00	£5,220.00	£0,000.00	£5,800.00
North Newnton Footway	£0,000.00	£5,000.00*	£0,000.00	£0,000.00
Littleworth Nameplates	£510.00	£410.00	£0,000.00	£510.00
A338 Shalbourne Carvers Hill warning signs	£1,200.00	£600.00	£0,000.00	£1,200.00
Burbage various roads 20 mph assessment	£2,500.00	£2,250.00	£0,000.00	£2,500.00
Rushall Elm Row Safety Audit	£1,200.00	£1,000.00	£0,000.00	£1,200.00
Woodborough Footway Improvements Topo	£1,400.00	£1,150.00	£0,000.00	£1,400.00
Totals	£84,169.04	£37,947.26	£35,787.82	£83,922.65

*Allocated but scheme yet to be agreed

Budget £37,815.93

Projected Spend £83,922.65

Balance -£46,106.72

Contributions (PTO)

Contributions		
Woodborough 20 mph Zone	£3,000.00	Woodborough Parish Council- invoice issued
Woodborough 20 mph Zone	£43,289.00	Substantive funding
C192 Speed Limit (Durley)	£300.00	Burbage Parish Council – invoice issued
Oare Gateways	£400.00	Wilcot Parish Council – invoice issued
C195 Speed Limit (Marten)	£300.00	Grafton Parish Council – invoice issued
Shalbourne 20 mph assessment	£300.00	Shalbourne Parish Council – invoice issued
Rushall Village Gates	£1512.00	Rushall Parish Council
Ram Alley Unsuitable HGVs signs	£100.00	Easton Parish Council
Bottlesford Unsuitable HGVs signs	£100.00	North Newnton Parish Council
Oxenwood Bend warning signs	£100.00	Shalbourne Parish Council
Manningford Direction Signs	£580.00	Manningford Parish Council
Littleworth Nameplates	£100.00	Milton Lilbourne Parish Council
A338 Shalbourne Carvers Hill warning signs	£600.00	Highways central fund
Burbage 20 mph assessment	£250.00	Burbage Parish Council
Rushall Elm Row Safety Audit	£200.00	Rushall Parish Council
Woodborough Footway Improvements Topo	£250.00	Woodborough Parish Council
	Total	£51,381.00
Overall Balance	£5,274.28	
Potential contribution		
North Newnton Footway	£15,000.00	North Newnton Parish Council – new scheme to be agreed

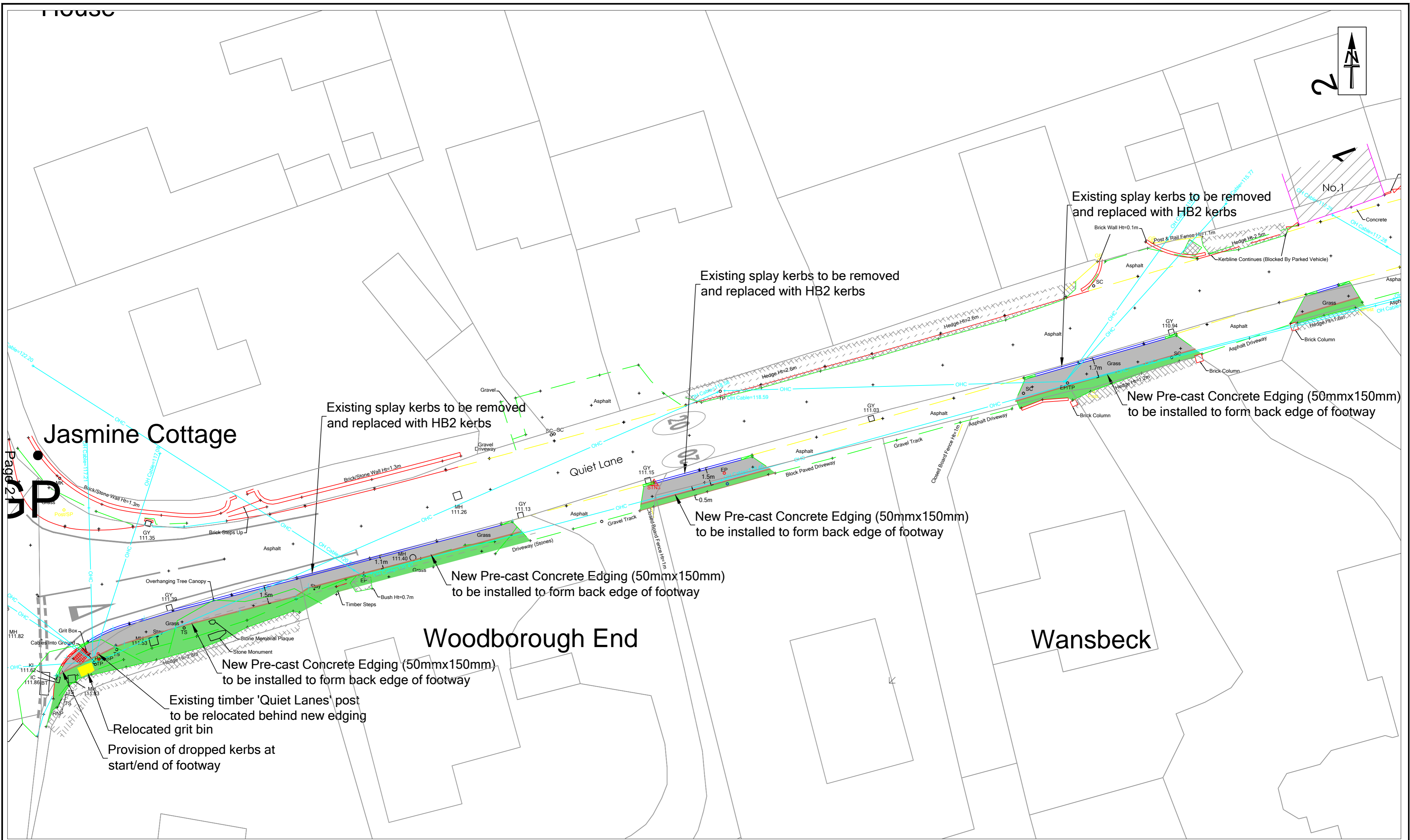
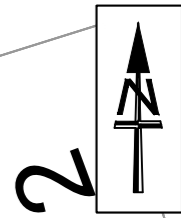

Page 2 of 2

- NOTES:
- Full footway construction consisting of: AC 6 dense surf 100/150 (20mm thick), AC 20 dense bin 100/150 (60mm thick) to BS EN 13108-2:2006, 225mm thick granular Type 1 sub-base.
 - Verge to be retained. Topsoil and grass seeding post construction as required.
 - 125 x 255mm pre-cast concrete kerb type HB2 (80 - 100mm upstand)
 - 125 x 255mm pre-cast concrete kerb type DR1/DL1
 - 125 x 150mm pre-cast concrete kerb type BN
 - 50 x 150mm type EF (Bullnosed) concrete edgings

Wiltshire Council
 Where everybody matters
Traffic & Network Management
 County Hall, Bythesea Road, Trowbridge
 Wiltshire, BA14 8JD
 Tel: 0300 4560100
 Website: www.wiltshire.gov.uk

This map is reproduced from Ordnance Survey material with the permission of Ordnance Survey on behalf of the Controller of Her Majesty's Stationery Office © Crown copyright.
 Unauthorised reproduction infringes Crown Copyright and may lead to prosecution or Civil Proceedings.
 Wiltshire Council (100049050) 2012

F					
E					
D					
C					
B					
A					
O	01/02/18	KR	***	***	ORIGINAL
REV	DATE	DRAWN	CHECK	APPROV	DESCRIPTION
DRAWING PURPOSE: DRAFT					

PROJECT: PEWSEY COMMUNITY AREA TRANSPORT GROUP WOODBOROUGH FOOTWAY	
DRAWING TITLE: FOOTWAY CONSTRUCTION DESIGN	
SCALES: 1:200	SHEET SIZE: A2
DRAWING NO.	REVISION: 0
FILE REF:	

This page is intentionally left blank

Briefing Note for Pewsey CATG

Area Board Issue 5640 – Sharcott Drove – Review of Warning Signs

Background

Sharcott Drove is an unclassified road which passes through the hamlet of East Sharcott. The hamlet is situated West of Pewsey village with main access from the A345. The development comprises of private dwellings including the Manor and working farms. There is no street lighting provision. The drove is subject to the National Speed limit of 60 mph but is mainly single track with formal passing places provided. There is a rail over-bridge with a maximum clearance of 15 feet, 3 inches.

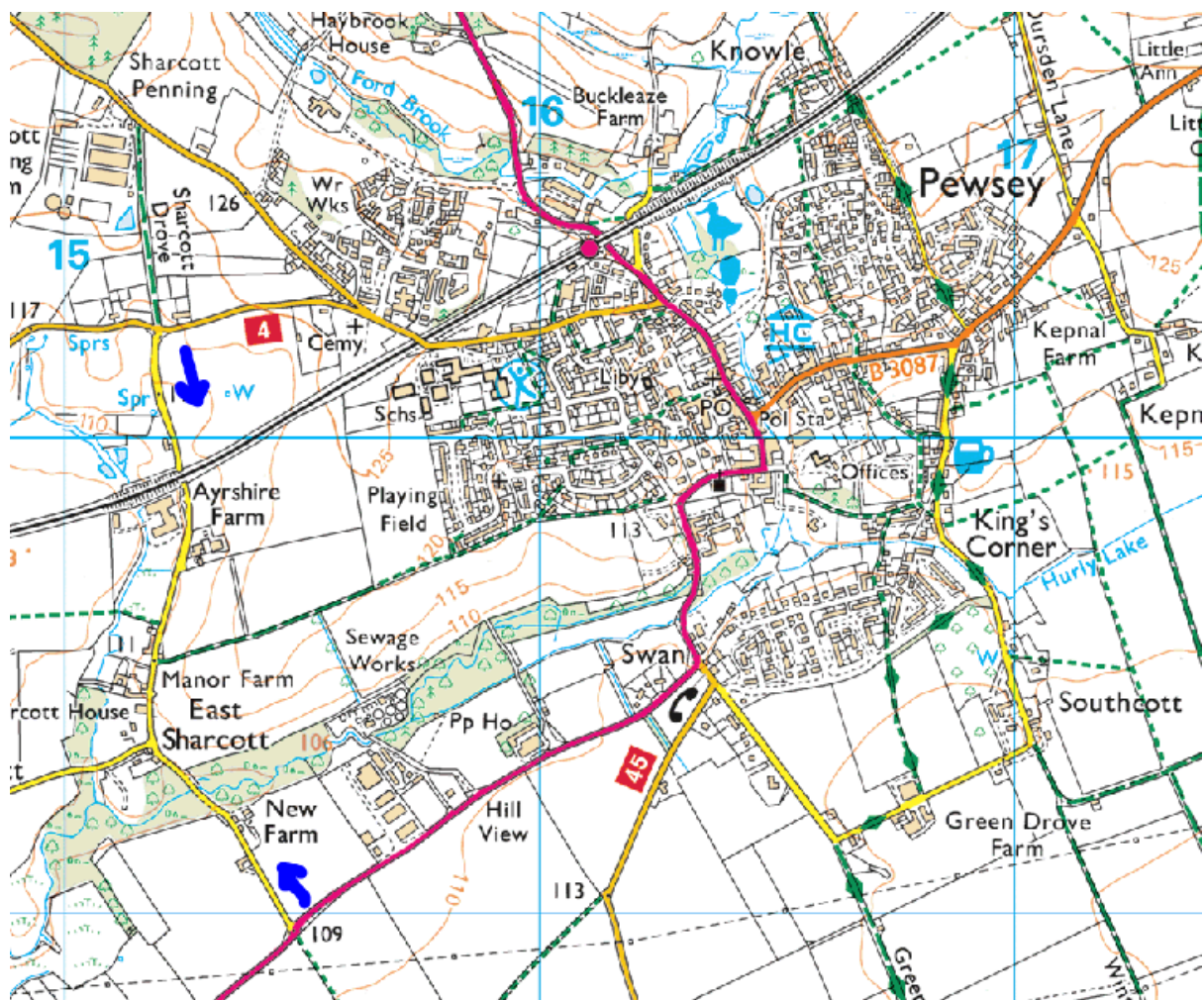

A recent metro count recorded average speeds of just 26.9 mph within the developed area and there have been no recorded personal injury collisions over the most recent 6 year period.

Current Sign Provision

There are signs provided at each end of the drove advising that the route is single track with passing places provided and at the southern end there is a sign "Unsuitable for HGVs."

Other signs give warning of the low bridge and highlight the formal passing places (to deter parking).

Recommendations

Consideration could be given to the provision of village nameplates "EAST SHARCOTT Please drive carefully" and warning signs of pedestrians in road. A SLOW road marking or false cattle grid markings could be provided alongside the nameplate to form a gateway feature into the hamlet.

Ball park costs (excluding temporary traffic management provisions) to install are as follows:

Single Nameplate on 2 posts = £300

SLOW marking = £75

Cattle Grid marking = £250

Warning sign on single post = £210

Mark Stansby
20/11/17

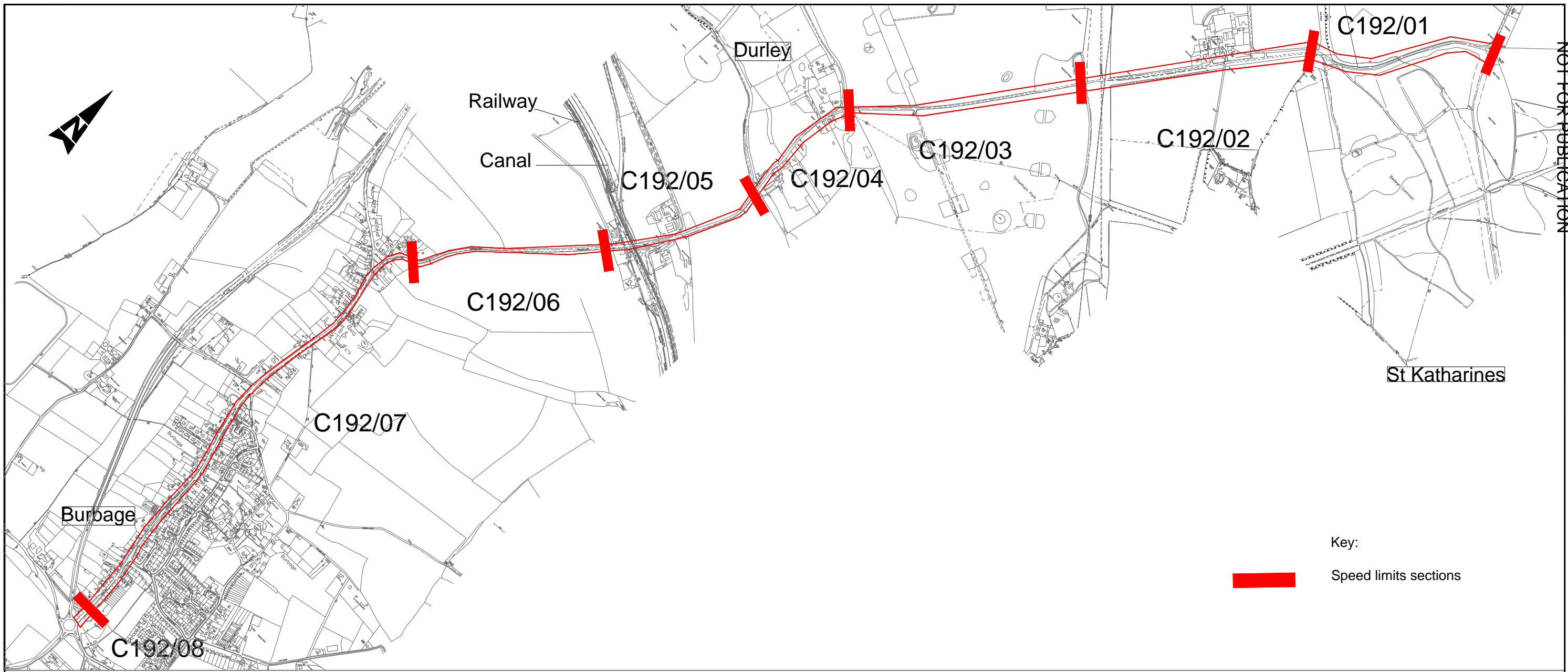

Key:
 Speed limits sections

C192											
Road Section	Description	Length	Existing (mph)	AADT	Collisions		Collision Rate	Mean Speed (mph)	Assessed Limit	Recommended Limit	Comments
					All	KSI					
C192-01	T Junction (Bedwyn Common) to St Katharines	705	60	1095	1	0	59.1	31.5	40	NSL	The existing environment controls mean speeds to a lower level than the assessed limit. Introducing a speed limit would not be effective and would be detrimental to the environment.
C192-02	St Katharines to St Katharine's Church	902	60	1095	1	1	46.2	42.0	50	NSL	Comment as above C192-01
C192-03	St Katharine's Church to Junction in Durley	887	60	1181	0	0	0.0	42.2	50	NSL	Comment as above C192-01
C192-04	Junction in Durley to the Savenake Road	500	60	1181	1	0	77.3	32.9	40	NSL	Comment as above C192-01
C192-05	Savenake Road to the canal/rail bridge	620	60	1410	1	0	52.2	37.5	40/50	NSL	Comment as above C192-01
C192-06	Canal/rail bridge to Burbage entrance	745	60	1410	0	0	0.0	34.7	50	NSL	Comment as above C192-01
C192-07	Burbage entrance to the petrol station	1881	30	1473	0	0	0.0	25.7	30	30	As existing. The northern terminal signs should be relocated to ensure their conspicuity. They should be moved northwards by about 20m and erected at the end of the southbound straight.
C192-08	Petrol station to the roundabout	71	60	1473	0	0	0.0	25.7	30	30	Short length between the roundabout and 30 mph limit
total		6311									

SAFETY, HEALTH AND ENVIRONMENTAL INFORMATION			
IN ADDITION TO THE HAZARDS/RISKS NORMALLY ASSOCIATED WITH THE TYPES OF WORK DETAILED ON THIS DRAWING, NOTE THE FOLLOWING SIGNIFICANT RESIDUAL RISKS			
CONSTRUCTION	NONE		
MAINTENANCE/CLEANING	NONE		
USE	NONE		
DECOMMISSIONING/DEMOLITION	NONE		

ATKINS
 Atkins Limited
 Consulting Engineers,
 County Gate, County Way
 Trowbridge, Wiltshire
 BA14 7FJ
 Tel: 01225 730360
 www.atkinsglobal.com

Wiltshire Council
 Where everybody matters

Client: Speed Limit Review Class 'C'

Sheet Size	Original Scale	Designed/Drawn	Checked	Authorised
A3	NTS	MC	JH	KNB
Status	Drawing Number	Date	Date	Date
S2	5146838-C192-ATK-DR-001	08/01/16	08/01/16	08/01/16
Rev				
				P3.0

THIS MAP IS REPRODUCED FROM ORDNANCE SURVEY MATERIAL WITH THE PERMISSION OF ORDNANCE SURVEY ON BEHALF OF THE CONTROLLER OF HER MAJESTY'S STATIONERY OFFICE. © CROWN COPYRIGHT. UNAUTHORISED REPRODUCTION INFRINGES CROWN COPYRIGHT AND MAY LEAD TO PROSECUTION OR CIVIL PROCEEDINGS. 100049050, 2014

This page is intentionally left blank

Pewsey			
Road	2018/19 Schemes	Treatment	
UC	Heath Lane, Buttermere	Surface Treatment	£42,077.28
UC	Smay Down Lane, Oxenwood	Surface Treatment	£13,005.30
A345	A345 Oare Village	Surface Treatment	£39,567.84
A345	A345 Woodbridge Rbt to Pewsey	Surface Treatment	£179,527.00
UC	Milkhouse Water, Pewsey	Surface Treatment	£16,150.38
C30	Church Street, Great Bedwyn	Surface Treatment	£60,000.00
UC	Raffin Lane, Pewsey	Surfacing	£83,447.83
C38	Broad Street, Woodborough	Surfacing	£63,390.00
	Total Schemes		£497,165.63
Road	Skid Resistance Improvements	Treatment	
A342	A342 East of Chirton (978978)	Retexture	£3,372.00
A342	A342 Charlton St Peter to Wilsford (978983)	Retexture	£1,180.20
B3087	B3087 Pewsey High Street at Ball Road (979571)	Retexture	£1,011.60
A346	A346 Burbage Bypass Rbt (975638)	Retexture	£3,416.96
A338	A338 Burbage Rbt to West Grafton (975499)	Retexture	£1,258.88
C74	C74 Jockey Green, Great Bedwyn (980347)	Retexture	£1,315.08
A4	A4 at Little Bedwyn junction (976067)	Retexture	£4,855.68
C38	C38 East Kennett to New Town (980302)	Retexture	£8,182.72
C38	C38 Alton Barnes to East Kennet (976882)	Retexture	£22,879.02
C8	C8 Alton Road, West Stowell (976682)	Retexture	£4,091.36
C8	C8 Alton Road, West Stowell (976727)	Retexture	£3,126.97
	Total Skid Resistance Sites		£54,690.47
Road	Reserve or future years sites – to be reviewed	Treatment	
UC	Astley Close, Pewsey	Surfacing	£69,320.16
UC	Kelston Road, Little Bedwyn	Surfacing	£36,667.12
A338	A338 Burbage Bends	Surfacing	TBC
A345	A345 Oare to Clench Common	Surface Treatment	£61,630.14
C269	Sunnyhill Lane, Pewsey	Surface Treatment	£68,076.62
A338	A338 Burbage to County Boundary	Surface Treatment	£549,669.12
	Total Future Sites		£785,363.16

This page is intentionally left blank